

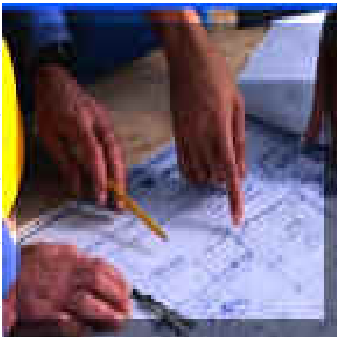

Division of Permitting and Development Review

- January 9, 2009
- Director's Development Data/Project Presentation to the County Commissioners



Building Permits Issued 2007 - 2008

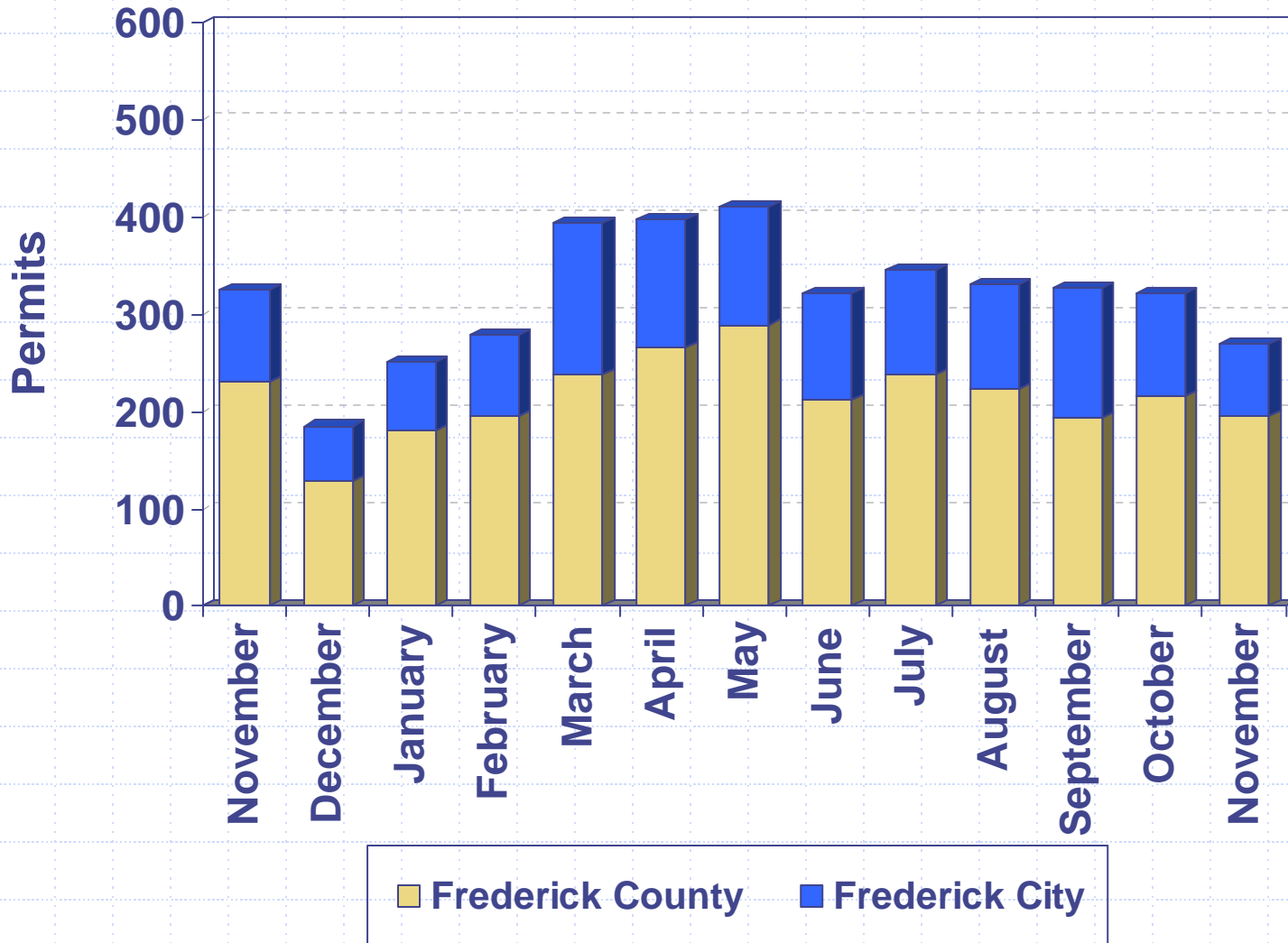

Housing Unit Construction 2007 - 2008

Housing units based on issued permits

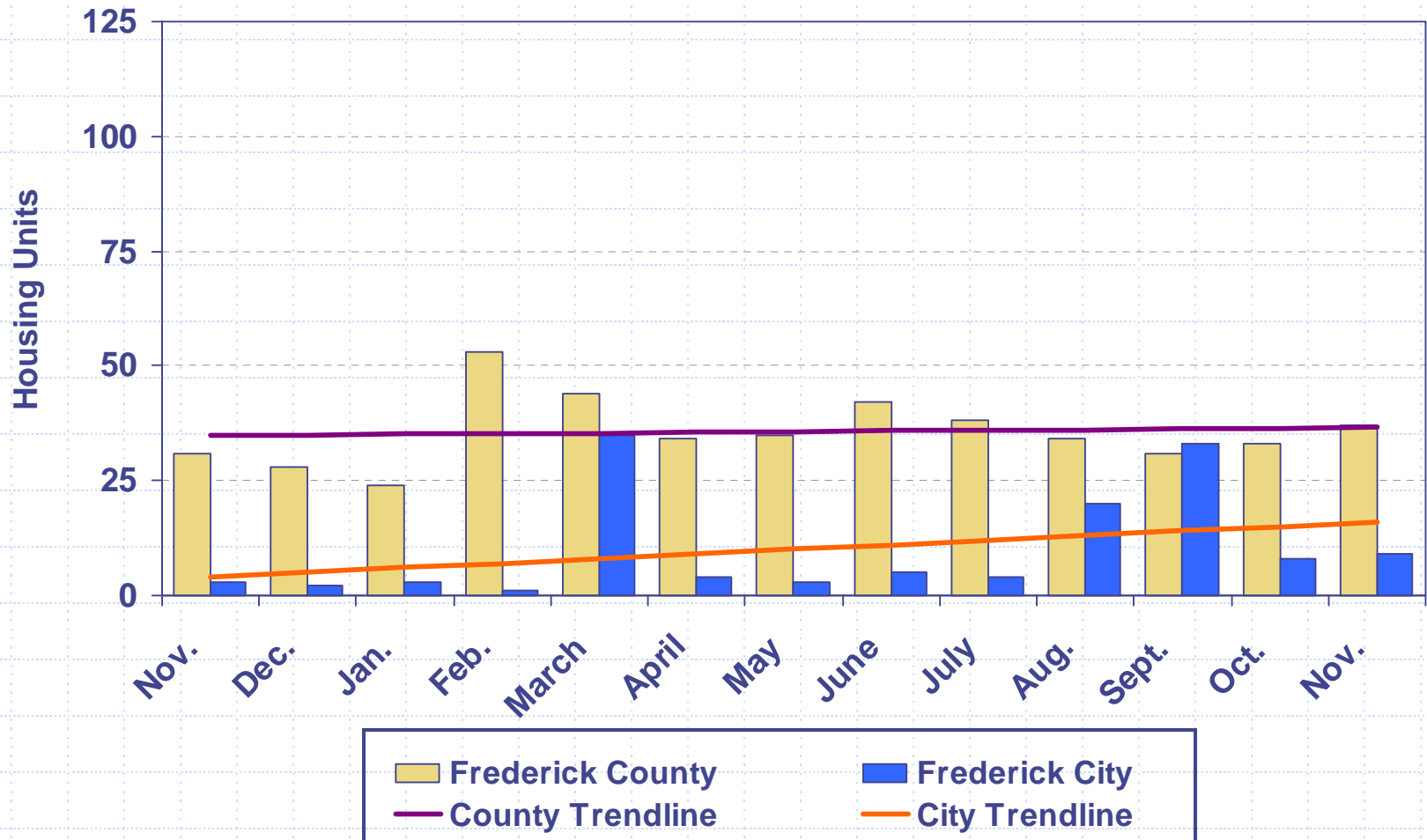

12 Month Total (December 2007 – November 2008): 560 units

Housing Unit Construction

Comparison of Current Month and YTD Units

Current Month – November 2008			
Year	County	City	Total
2008	37	9	46
2007	31	3	34
2006	54	25	79
2005	73	30	103
2004	63	19	82
5 Year Avg.	52	17	69

YTD – November 2008			
Year	County	City	Total
2008	405	125	530
2007	761	263	1,024
2006	860	333	1,193
2005	1,421	683	2,104
2004	966	489	1,455
5 Year Avg.	883	379	1,261

Construction Costs 2007 - 2008

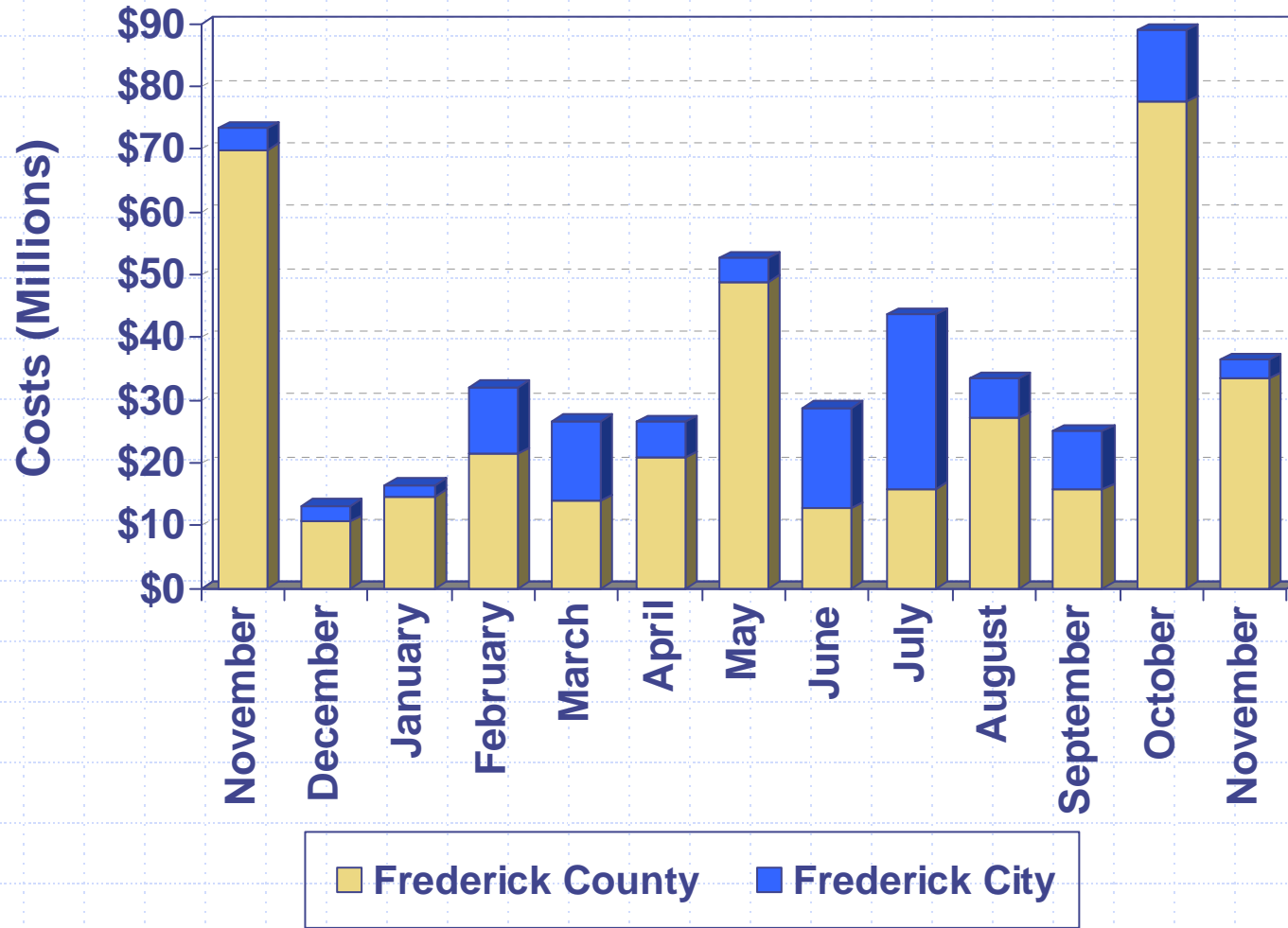

Costs based on issued permits

Commercial Construction Costs

2007 - 2008

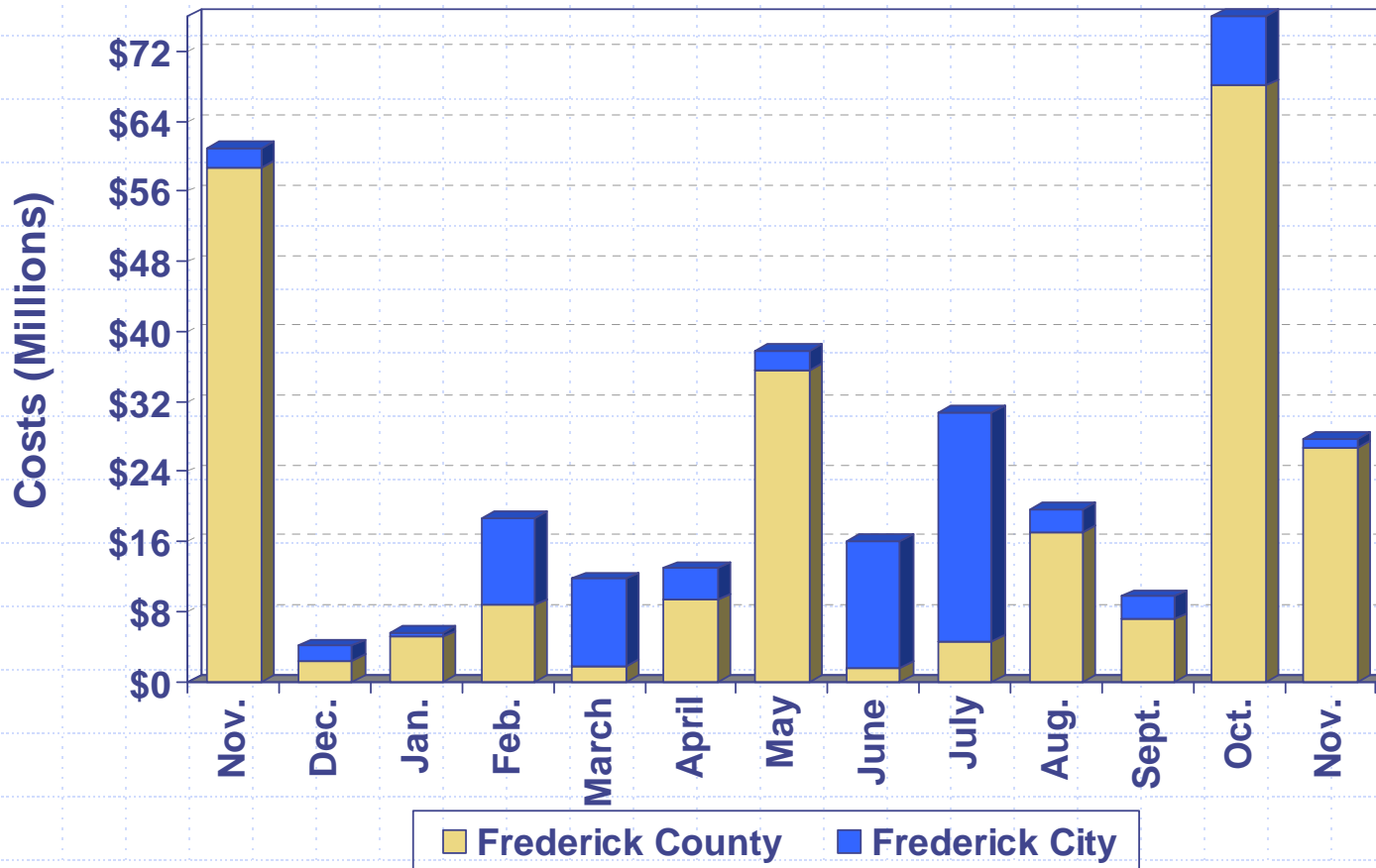

Cost per month:

Costs based on issued permits

Nov. 2007 Co. – New Design Road Treatment Plant (\$51M)

Feb. 2008 City – Charles River Labs Alteration (\$8.2M)

March 2008 City – Riverside Corporation (\$6M)

May 2008 Co. – Mount Saint Mary's University building alterations (\$24M)

June 2008 City – West Frederick Middle School new construction (\$13.9M)

July 2008 City – Frederick Community College classrooms/student center (\$18M)

Aug. 2008 Co. – Ben's Branch Pumping Station (\$4.4M) & Shockley Honda addition (\$4M)

Oct. 2008 Co. – Linganore High School new construction (\$59.2M)

Nov. 2008 Co. – Lonza Walkersville, Inc. new construction (\$20M)

Excise Tax 2007 - 2008

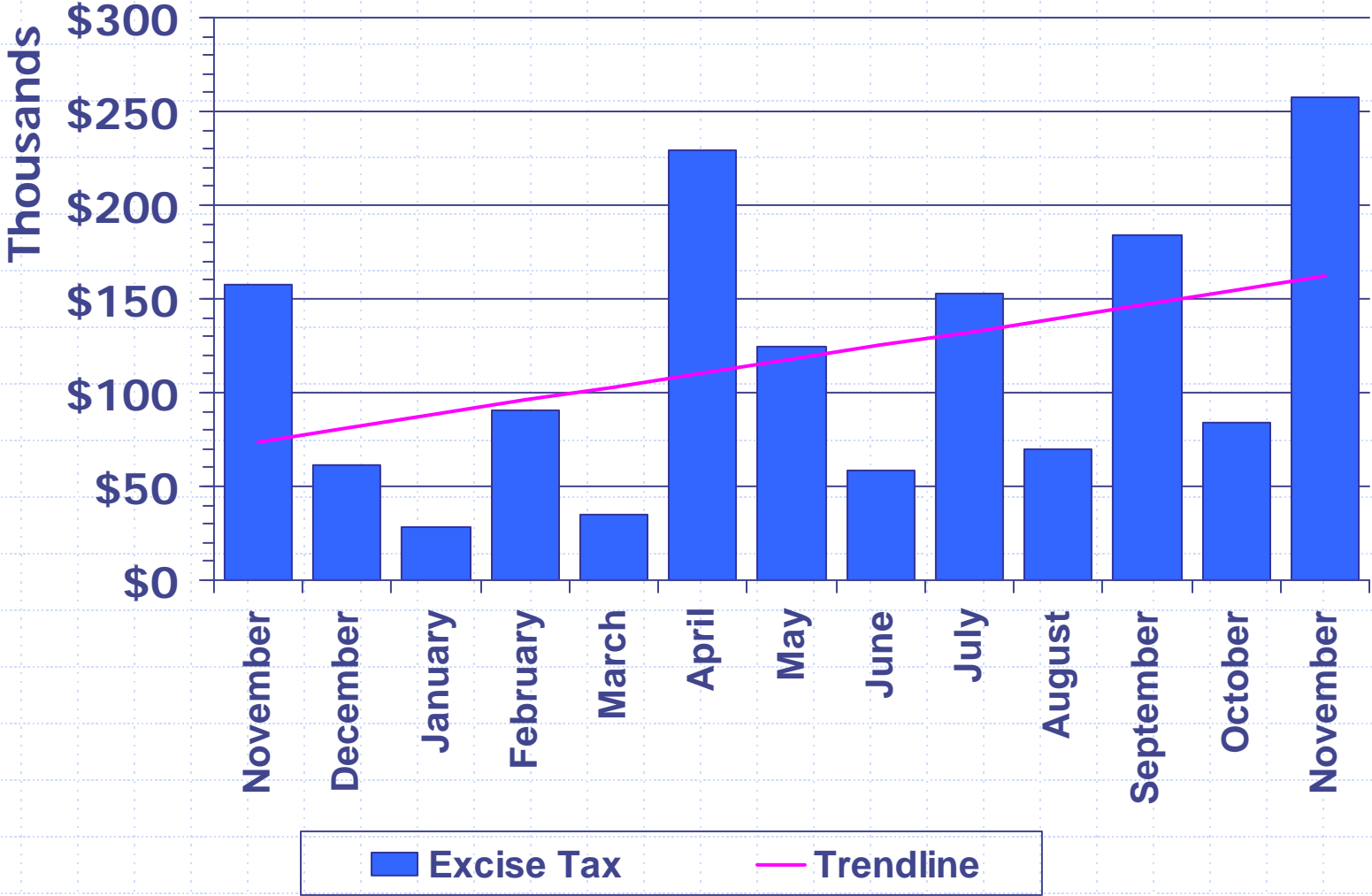

Impact Fee 2007 - 2008

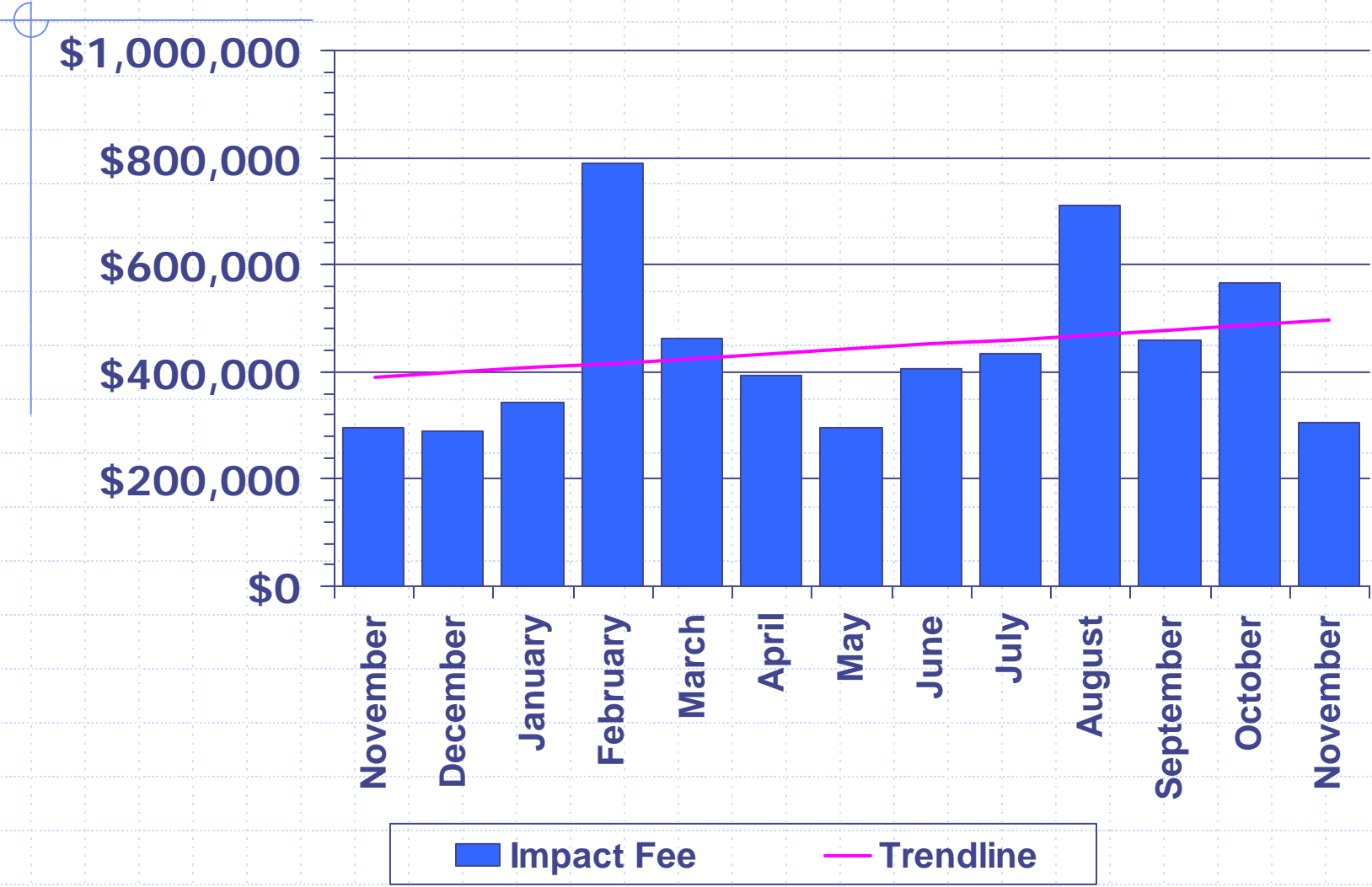

LIST OF PROJECTS

(expected to be presented
at upcoming FcPc meeting)

County Projects

1. **Wedgewood Wellington III**
2. **Mount Saint Mary's Flynn Hall expansion**

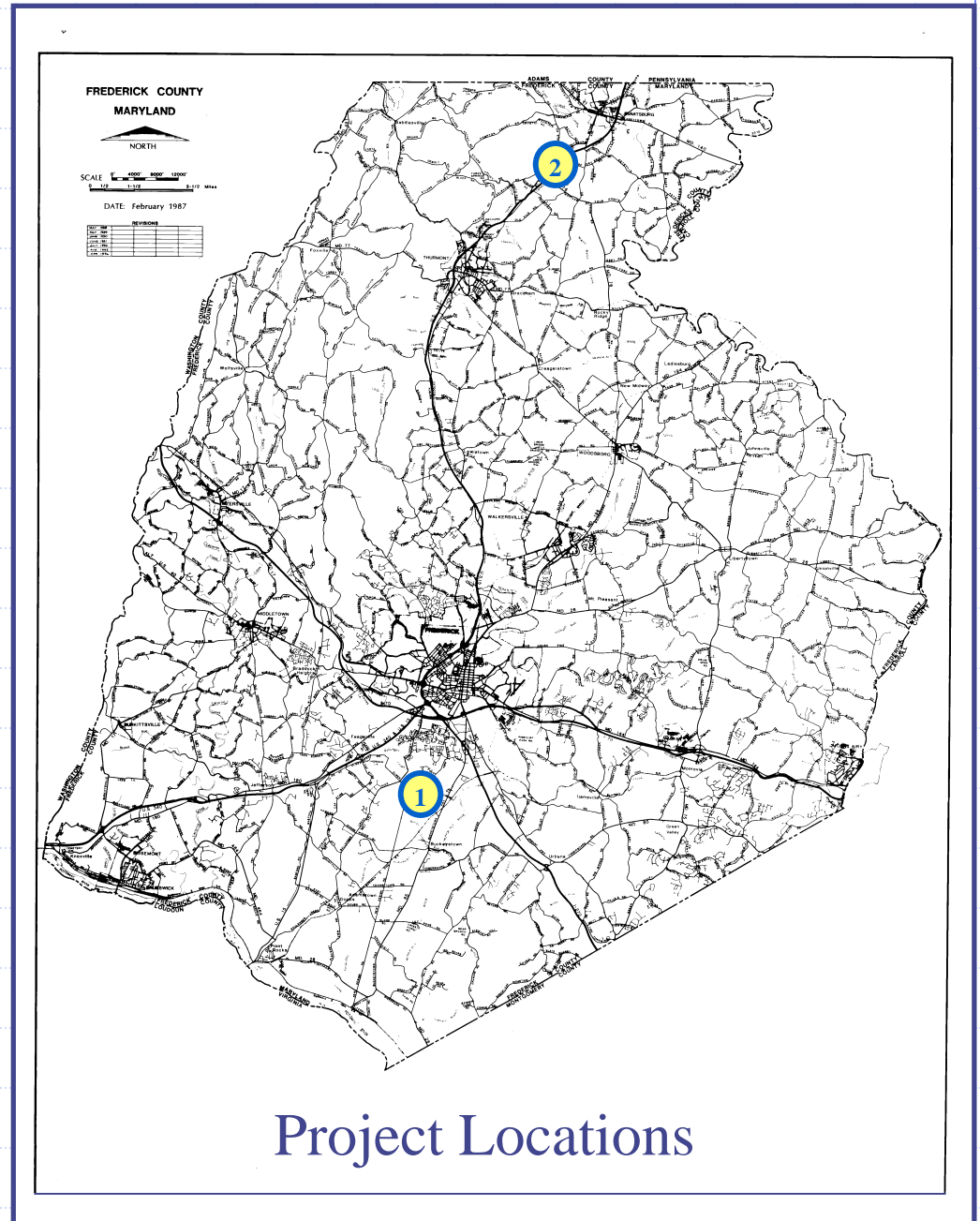



County Projects

Wedgewood Wellington III

- ❑ Request: Site Plan Approval
- ❑ Location: Corner of English Muffin Way and New Design Road
- ❑ Total Use: One 32,960 sq ft. office/warehouse/showroom
- ❑ Zoned: Limited Industrial
- ❑ Applicant: The Matan Companies
- ❑ Engineer: Harris, Smariga & Associates, Inc.

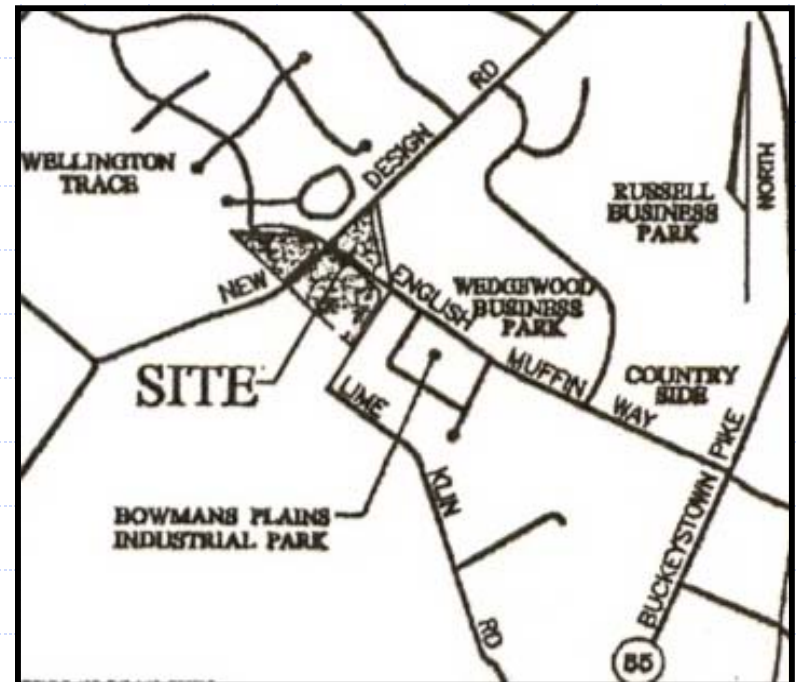

Wedgewood Wellington III

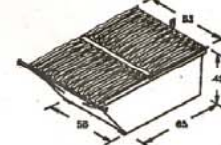
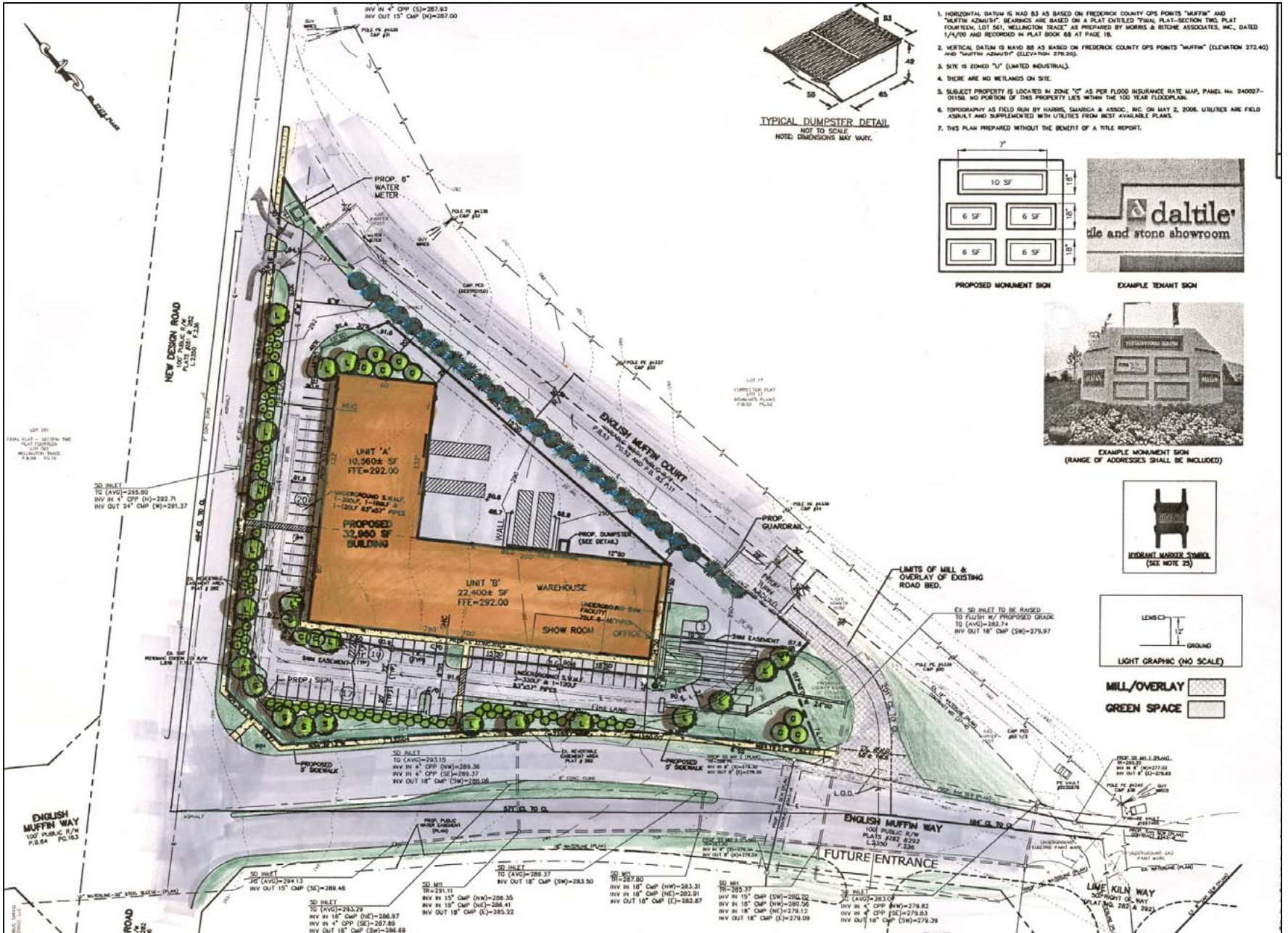

- HORIZONTAL DATUM IS NAD 83 AS BASED ON FREDERICK COUNTY GPS POINTS "MUFFIN" AND "MUFFIN AZIMUTH". BEARINGS ARE BASED ON A PLAT ENTITLED "FINAL PLAT-SECTION TWO, PLAT FOURTEEN, LOT SIX, WEDGWOOD TRACT" AS PREPARED BY MORRIS & RITCHE ASSOCIATES, INC., DATED 1/4/00 AND RECORDED IN PLAT BOOK 68 AT PAGE 16.
- VERTICAL DATUM IS NAVD 88 AS BASED ON FREDERICK COUNTY GPS POINTS "MUFFIN" (ELEVATION 272.40) AND "MUFFIN AZIMUTH" (ELEVATION 278.20).
- SITE IS ZONED "I-J" (LIMITED INDUSTRIAL).
- THERE ARE NO WETLANDS ON SITE.
- SUBJECT PROPERTY IS LOCATED IN ZONE "C" AS PER FLOOD INSURANCE RATE MAP, PANEL No. 240027-0158. NO PORTION OF THIS PROPERTY LIES WITHIN THE 100 YEAR FLOODPLAIN.
- TOPOGRAPHY AS FIELD RUN BY MORRIS, GUARACIA & ASSOC., INC. ON MAY 2, 2006. UTILITIES ARE FIELD ASBUILT AND SUPPLEMENTED WITH UTILITIES FROM BEST AVAILABLE PLANS.
- THIS PLAN PREPARED WITHOUT THE BENEFIT OF A TITLE REPORT.

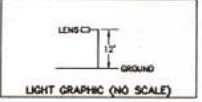
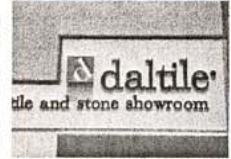
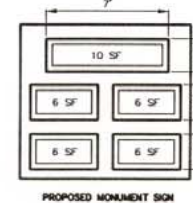

ENGLISH MUFFIN WAY
100' PUBLIC R/W
P.5.64 P.6.163

NEW DESIGN ROAD
PLAT 2805 R/W
L.2350 P.1.28

ENGLISH MUFFIN WAY
100' PUBLIC R/W
PLATS 2383 & 292
L.2350 P.2.26

FUTURE ENTRANCE

LIME KILN WAY
20' RIGHT OF-WAY
PLAT NO. 292 & 293

SO INLET
TO (AVG)=294.13
INV OUT 15" CMP (SE)=289.48

SO MI
TR=291.11
INV IN 15" CMP (NW)=286.35
INV IN 15" CMP (NE)=286.41
INV OUT 18" CMP (E)=285.22

SO INLET
TO (AVG)=289.37
INV OUT 18" CMP (SW)=283.50

SO MI
TR=287.80
INV IN 18" CMP (NW)=283.31
INV IN 18" CMP (NE)=282.81
INV OUT 18" CMP (E)=282.87

SO MI
TR=285.77
INV IN 15" CMP (SW)=280.22
INV IN 15" CMP (NW)=280.20
INV IN 18" CMP (NE)=279.12
INV OUT 18" CMP (E)=278.09

SO INLET
TO (AVG)=283.07
INV IN 4" CMP (SE)=279.83
INV IN 4" CMP (SW)=279.83
INV OUT 18" CMP (SW)=279.39

Mount Saint Mary's Flynn Hall expansion

- ❑ Request: Site Plan Approval
- ❑ Location: North side of Old Emmitsburg Rd., behind McGowan Student Center
- ❑ Total Use: 1,709 sq. ft. expansion of Flynn Hall
- ❑ Zoned: Agricultural
- ❑ Applicant: Mount Saint Mary's University
- ❑ Engineer: Harris, Smariga & Associates, Inc.

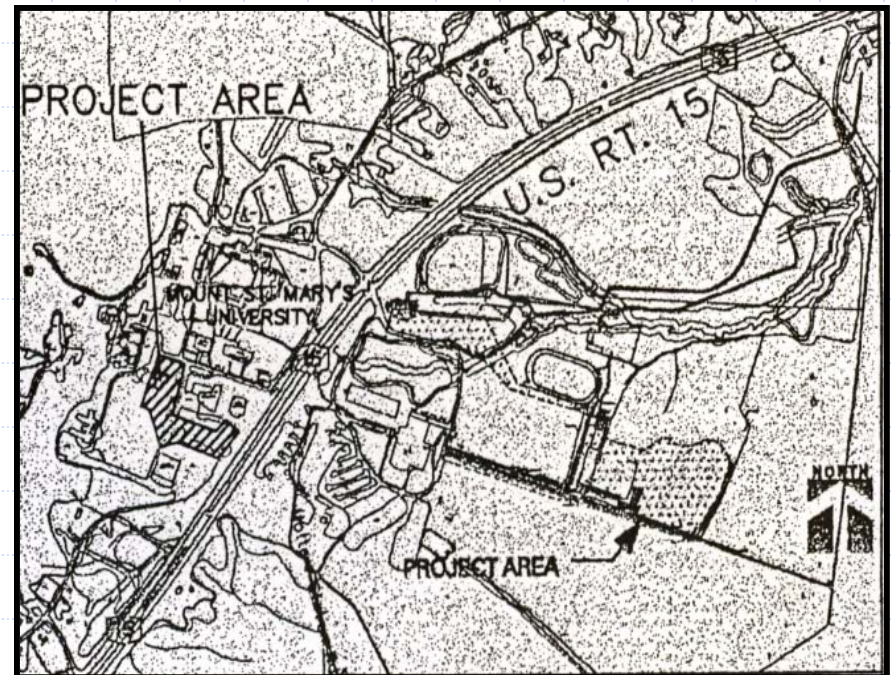

Mount Saint Mary's Flynn Hall expansion

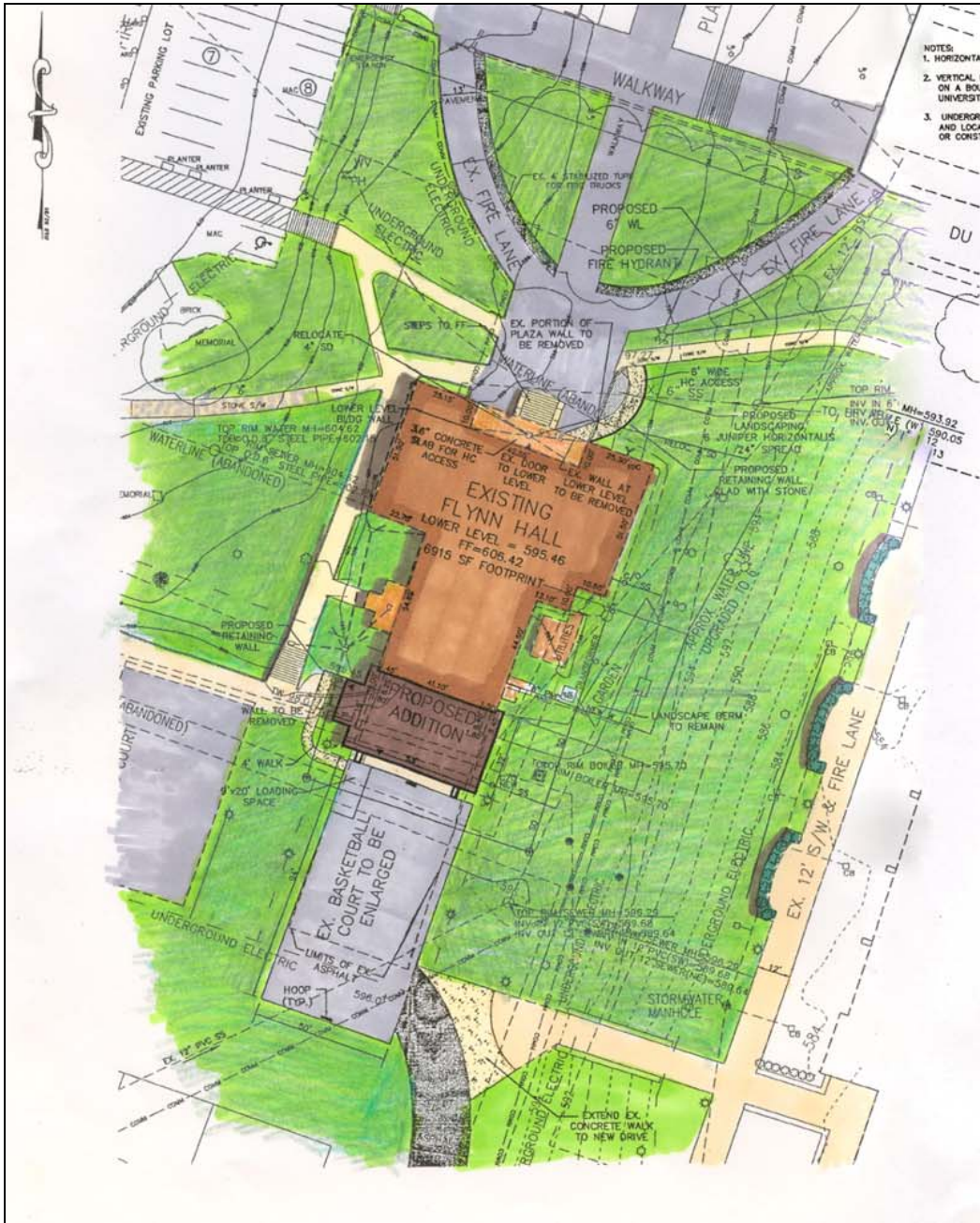

- NOTES:
1. HORIZONTAL DATUM IS MARYLAND STATE GRID NORTH (NAD83)
 2. VERTICAL DATUM NAVD 80 (D.P.S. CONTROL POINT AS SHOWN ON A BOUNDARY AND TOPOGRAPHIC SURVEY OF MOUNT ST. MARY'S UNIVERSITY, CONCRETE MONUMENT PANEL 11 AS SHOWN, ELEV. 585.75)
 3. UNDERGROUND UTILITIES LOCATED FROM EXISTING ABOVE GROUND EVIDENCE AND LOCATIONS ARE APPROXIMATE AND/OR UNKNOWN. BEFORE ANY DESIGNING OR CONSTRUCTION, CONTACT MISS UTILITY.

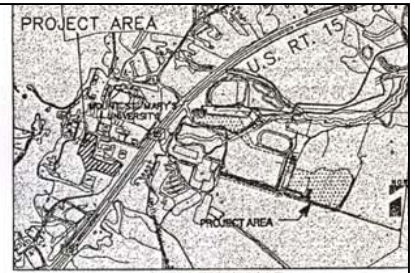

LOCATION MAP

SCALE: 1" = 2,000'
TAX MAP B PARCEL 48 TAX ID #05-177696

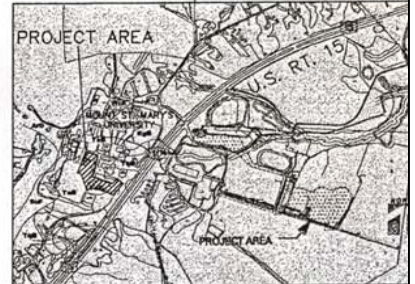

SOILS MAP

SCALE: 1" = 2,000'

TRUCK MOVEMENT

SCALE: 1" = 30'

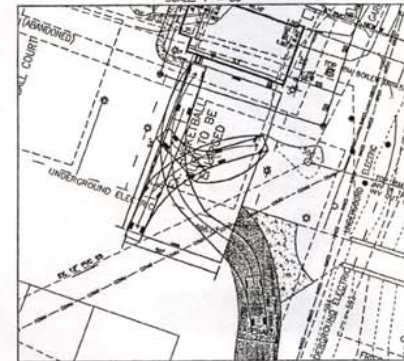

Harris, Smariga & Associates, Inc.
Planners/Engineers/Surveyors
125 South Carroll Street, Suite 100, Frederick, MD 21701
301-662-4488 / FAX 301-662-6906

REVISIONS:

12-08 REV. PER STUDY COMMENTS	

SITE PLAN
MOUNT SAINT MARY'S
UNIVERSITY
DELAPLAINE FINE ARTS CENTER

EMMITSBURG ELECTION DISTRICT No.5
FREDERICK COUNTY, MARYLAND

SITUATED ON U.S. ROUTE 15
EMMITSBURG ELECTION DISTRICT No.5
FREDERICK COUNTY, MARYLAND

SCALE	1"=20'
DRAWN	BY: VLE
CHECKED	BY: CM
DATE	SEPTEMBER 23
SHEET	2
OF	3
PROJECT	6737
	4