

PLAN
SCALE: 1/4" = 1'-0"

SHEET NO. 2
 $\Delta = 10' 55' 15"$
 $R = 637' 54"$
 $E = 530.31'$
 $T = 103.27'$
 $L = 102.50'$
 $K = 7.28'$

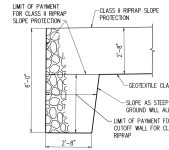

SIDE CUTOFF WALL
SCALE: 1/2" = 1'-0"

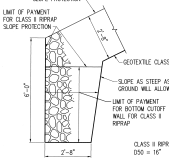

BOTTOM CUTOFF WALL
SCALE: 1/2" = 1'-0"

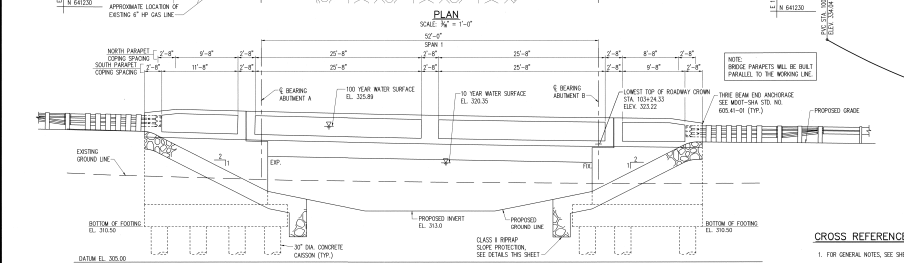

ELEVATION
SCALE: 3/4" = 1'-0"

NOTE: DURING NORMAL CONDITIONS, THE NORMAL WATER SURFACE ELEVATION IS AT/NEAR THE PROPOSED GROUND LINE.

PROFESSIONAL CERTIFICATION
 I CERTIFY THAT THIS DOCUMENT WAS PREPARED OR APPROVED BY ME, AND THAT I AM A PROFESSIONAL ENGINEER UNDER THE LAWS OF THE STATE OF MARYLAND. LICENSE NO. 46175 EXPIRATION DATE: JANUARY 16, 2020



WB
 CONSULTING ENGINEERS
 THE WILSON T. BALLARD CO.
 OWINGS MILLS, MD

CROSS REFERENCE NOTES

1. FOR GENERAL NOTES, SEE SHEET NO. S1-2

VERTICAL CURVE
SCALE: 1" = 30'-0" VERT.
1" = 3'-0" HORIZ.

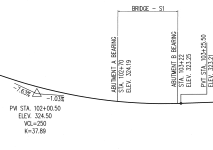

S1-1

FREDERICK COUNTY, MARYLAND
 DEPARTMENT OF ENVIRONMENT AND CONSTRUCTION MANAGEMENT
 OFFICE OF TRANSPORTATION ENGINEERING
 PROJECTS DIVISION

IMPROVEMENTS TO GAS HOUSE PIKE AT LINGANORE CREEK
CONSTRUCTION OF BRIDGE NO. F09-25

GENERAL PLAN AND ELEVATION
 DATE: APRIL 2019 SCALE: AS SHOWN

CONTRACT NO. C6057-6007-01 DWG. 35 OF 107

DATE PLOTTED: 04/16/2019 10:44:43 AM